

Bullard Close

STOKES CROFT

APPROXIMATE FLOOR AREA
52 SQM / 599 SQFT



GROUND FLOOR
559 sq.ft. (52.0 sq.m.) approx.

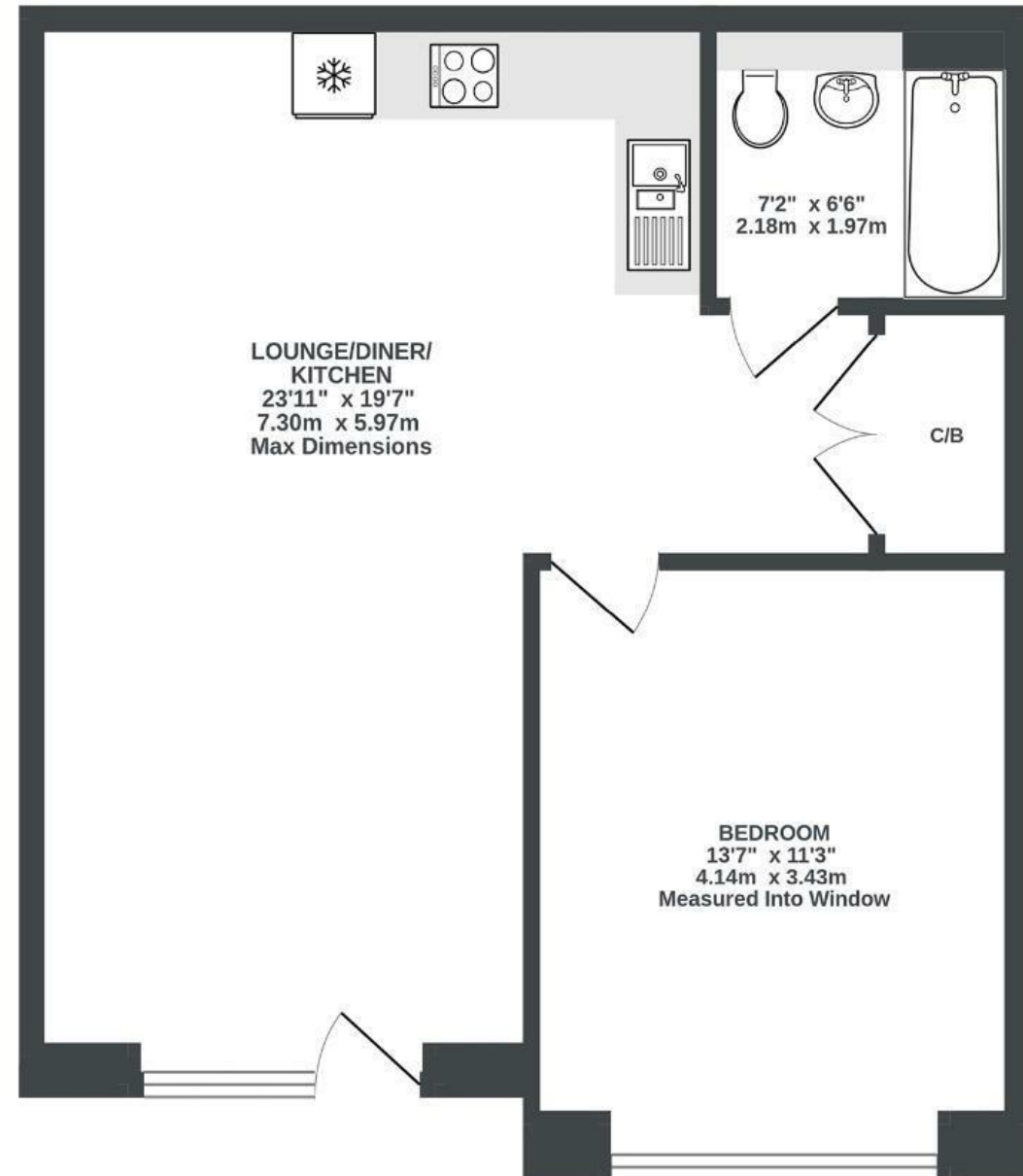

Illustrations are for reference purposes only, measurements are approximate, not to scale.

STOKES CROFT, BRISTOL



£250,000



1 Bedrooms



BS6 5EQ



1 Bathrooms

"We love the buzz of Stokes Croft and the friendly Carriageworks community, with brilliant cafés, bars, and some of Bristol's best food on our doorstep. At home it's modern, cosy, and surprisingly quiet - Bullard Close is a hidden, safe corner shared with our neighbours, so evenings on the sofa feel properly peaceful."

